

Card reader

PART #: SSH-Z1970-A00

KEY FEATURES

- 14.60Lx12.50Wx1.35H mm
- Nano SIM pin push tray type
- Mechanical lifetime Min. 1000 mating cycles
- Modular solution

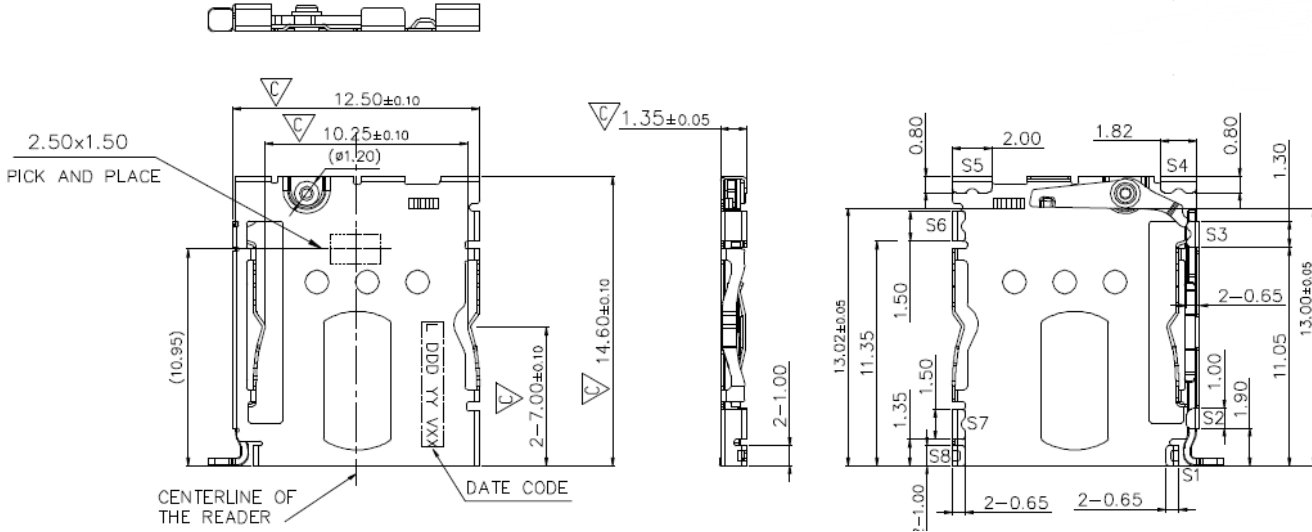
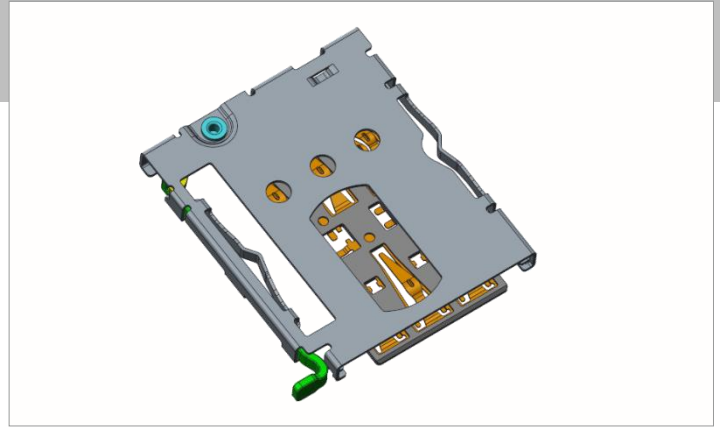

Recommend FLEX Layout

Recommend tolerance: ± 0.05
 Recommend Stencil Thickness: 0.10

